



THE UNIVERSITY of TEXAS SYSTEM
FOURTEEN INSTITUTIONS. UNLIMITED POSSIBILITIES.

GUADALUPE HALL

Alamo ARCHITECTS

WT WHITING-TURNER

TREANORHL

Tobin Shut Down Between 2/15/21 - 4/16/21 for curb, sidewalk and loading dock construction. Recommend parking area closure due to tight entrance.

Entrance to Roadrunner Cafe remains open

Legend

- Area of Civil Work
- New Sidewalk
- Perimeter Fence
- SWPP Track out Mats

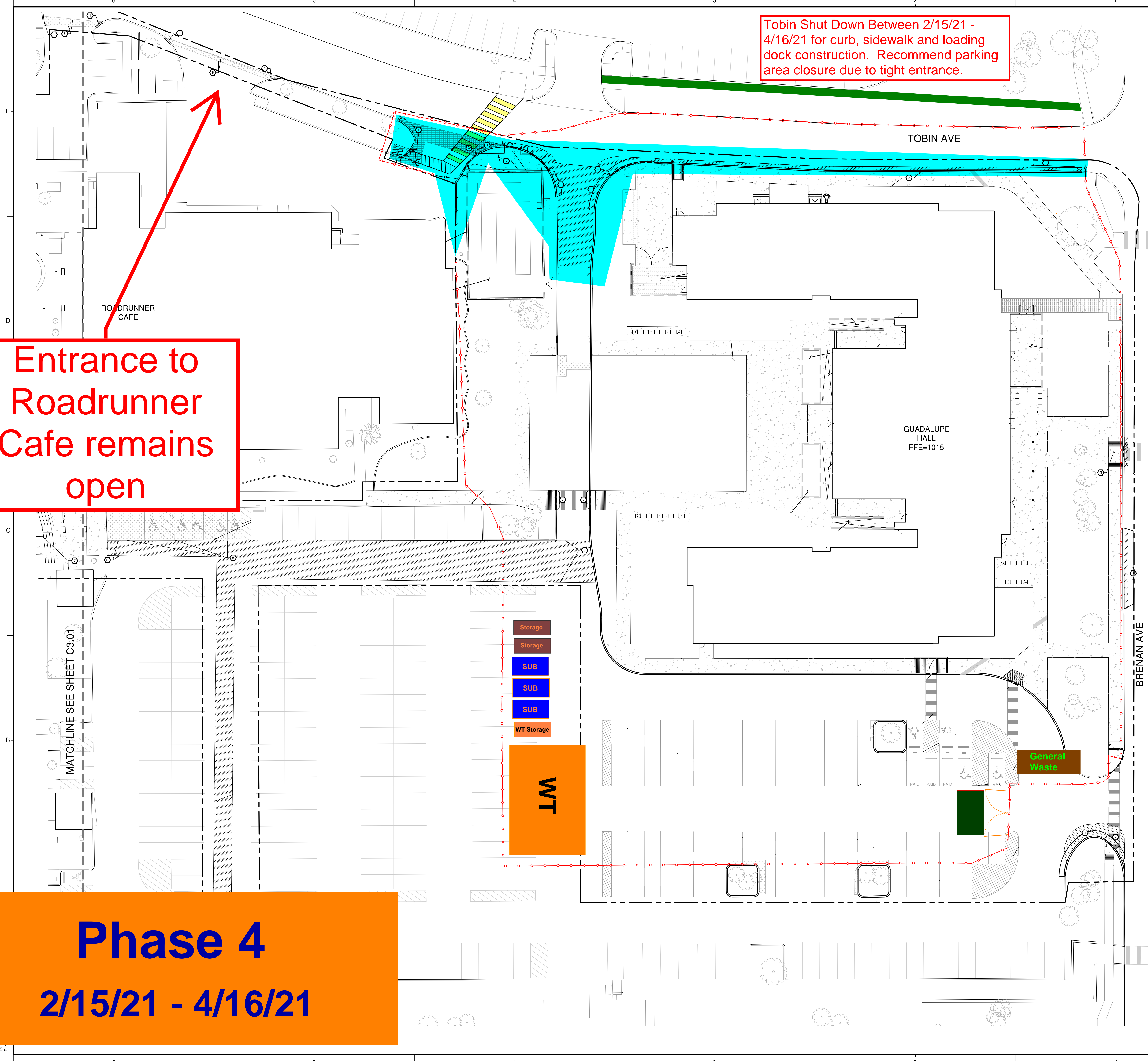

Phase 4
2/15/21 - 4/16/21

SCALE: 1" = 20'
0' 20' 40' 60'